

## Orange Farm Community Facilities

### M.I.P. Studiowork Excercise

#### 1.1: Modimo o Moholo Daycare Centre for the Disabled.

In this structure, the functional idea was to create a building that can combine a daycare facility with a training centre to care for disabled members of a community. Administrative areas are of course also added to the utility of the building, which forms the plan and the facades. The dynamic use of open plan, roofed areas that interlink extends the design to its varied functions.

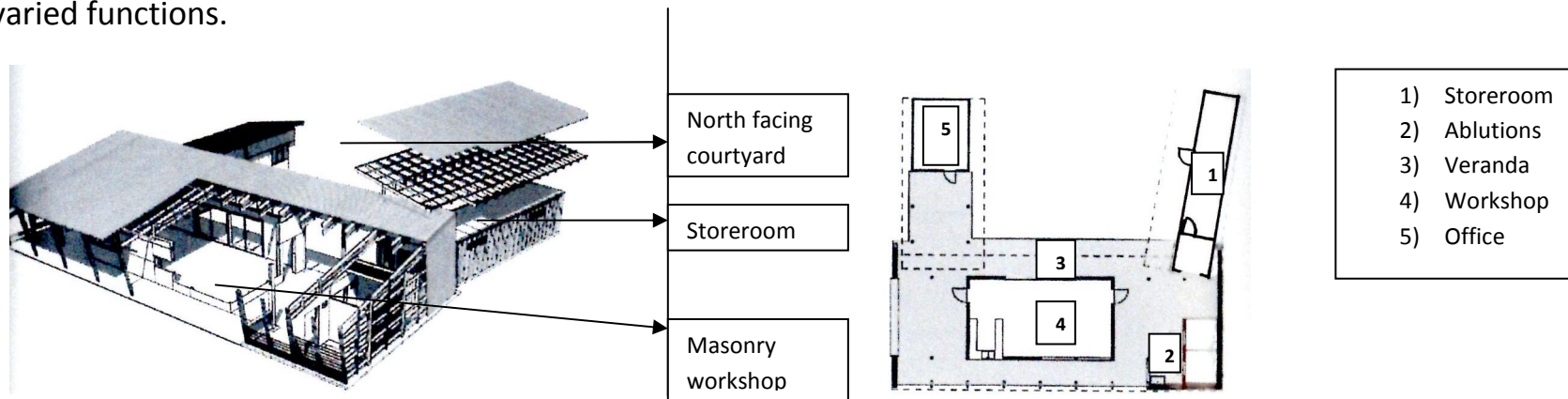

Axonometric Sectional

Floor Plan

1.2: Diagram Reflecting the functional idea behind the design.

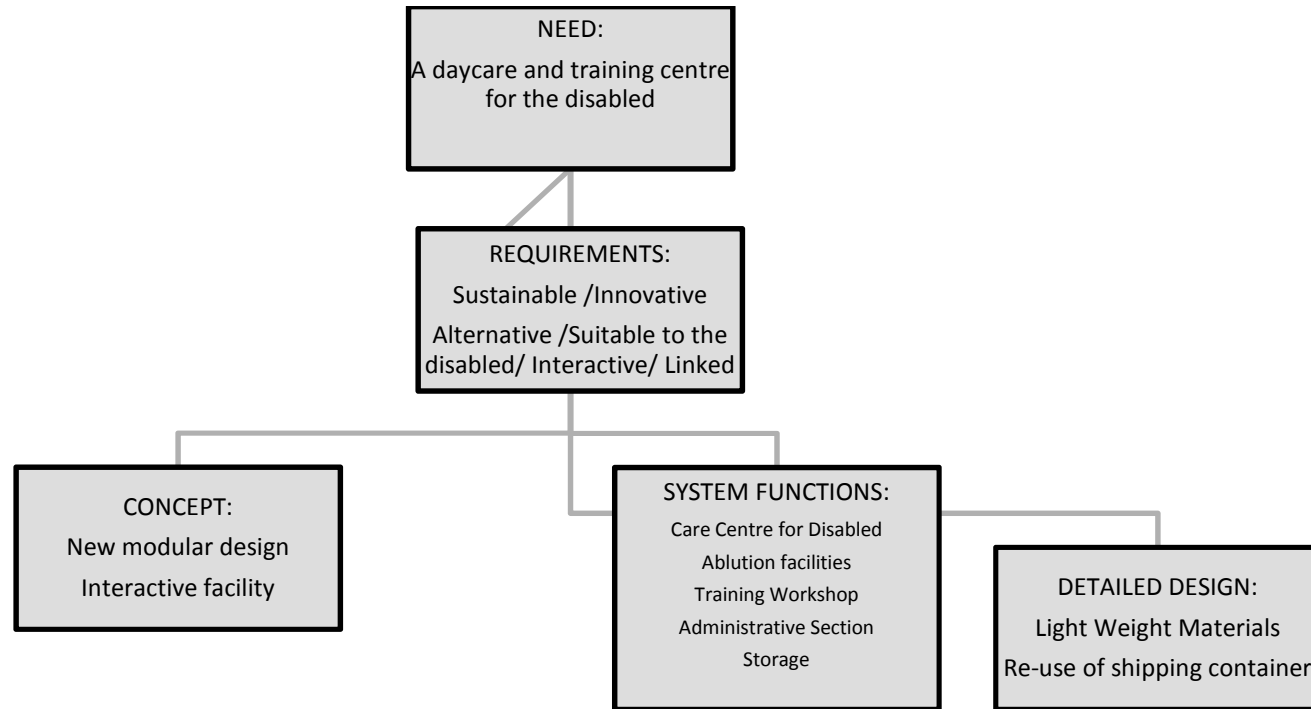

The building consists of a different areas connected via large overlapping corrugated roof sheets over a veranda. The central function of a workshop, which is built from light materials, is placed in the centre where all other facilities branch off from. An office and store room fashioned out of a used shipping container is juxtaposed to the verandas, creating the plan and the elevations. Polycarbonate sheets are used as cladding to probably enhance natural light and limit the use of artificial lighting. Sanitary masonry ablutions complete the plan.

1.3: Diagram reflecting the functional organization in the design

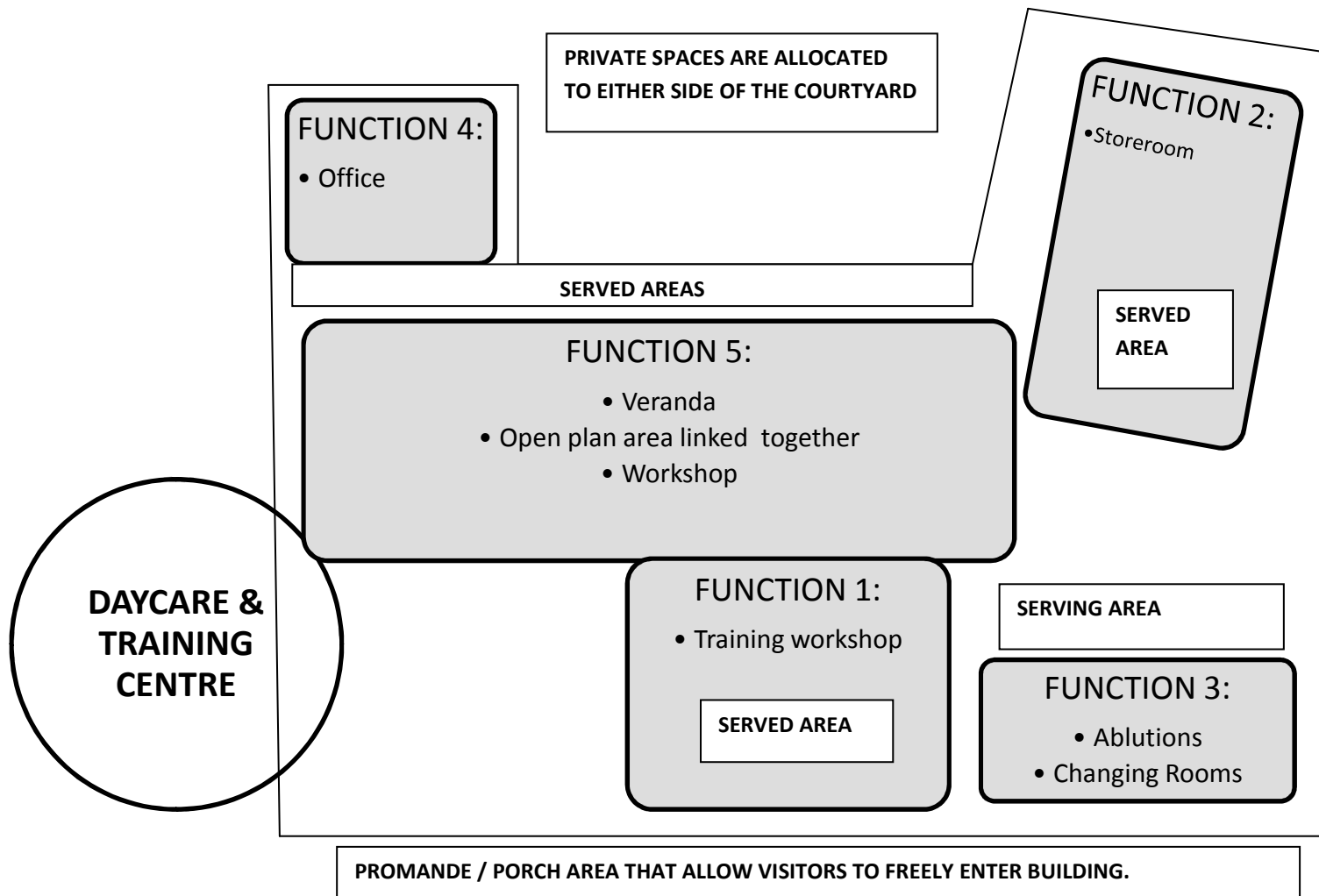

## 2: QUESTIONS

\*Does this structure challenge traditional building concepts?

-Yes; providing a rational structure where a community can be involved with their disabled members.

\*Is there Architectural, elementary order?

-Yes; lightweight frame, masonry core, interlinked verandas, spaces are defined and not enclosed.

\* Does the technology in the construction develop or support the concept?

-Support yes; looking at the site pictures, one can see that the area surrounding the facility is not affluent and thus deem a lighter, cost effective structure more prudent than conventional training centers. The structure accedes to vernacular ideas and built styles adjoining it.

## 3: References:

Righini P, Thinking Architecturally, 2009

Hilderling C, Digest of South African Architecture, 2009, p108-109